



# VIKING LOGE

THE WOLSTEIN  
CENTER  
CONFERENCE  
PAVILION



# VIKING

# LOGE

## THE WOLSTEIN CENTER CONFERENCE PAVILION

ROOMS	DIMENSIONS	SQUARE FOOTAGE	THEATRE	CLASSROOM	BANQUET	STANDING RECEPTION
East Wing	88x40x11	3520	400	150	250	450
Room A	25x40x11	1000	80	40	48	60
Room B	25x40x11	1000	80	40	48	60
Room C	38x40x11	1520	150	60	64	150
West Wing	84x54x11	4356	450	250	300	500
Room D	25x54x11	1350	80	50	56	60
Room E	26x54x11	1404	80	50	56	60
Room F	33x54x11	1782	175	70	72	150
VIP Room	30x60x11	1800	200	80	100	200
Grand Ballroom	112x212	24,000	3,000	1,200	1,200	300
Backstage Café	100x20	2000	224	132	144	280

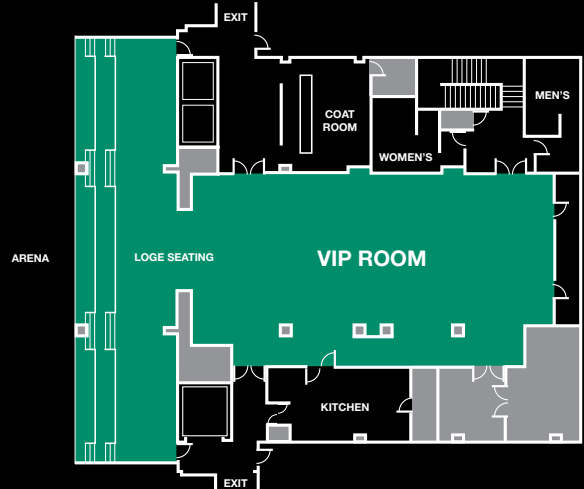



### Notable Features:

- Capacity of up to 200
- Separate Men's and Women's restroom located directly off main room.
- Full private coat room
- Expansive view overlooking the arena.
- Full array of presentation equipment, device hookups and wireless internet access.



### The VIP Viking Loge

is located on the 5th Floor of the Conference Pavilion.

This space overlooks the Arena and is perfect for any banquet, conference or VIP reception for groups up to 200 people.

Private loge space for events is available for groups of 25.





## VIKING LOGE

### **The Bert L. & Iris Wolstein Center**

at Cleveland State University

2000 Prospect Ave.

Cleveland, Ohio 44115

216.687.5239

[wolsteincenter.com](http://wolsteincenter.com)

© Cleveland State University